

## The Price: Guesstimating

A simple roof with one easy size of truss might run under \$2 Canadian/sq ft. The roof area is the covered area, not just indoors.

- **Add 20%** for a simple symmetrical vault.
- **Add 20%** for an energy heel.
- **Add 20%** and more if the overhang runs at the same height as the ceiling.
- **Add 30%** to get a hipped roof.
- **Add 50%** for irregular vaulting.
- **Add 50%** for a steep 12/12 pitch.
- **Add 100%** for steep, fancy, interlocking roofs.
- **Add extra** if the roof and ceiling slopes are less than 2.5/12 apart. It's hard and sometimes impossible to stiffen a shallow truss.
- **Allow** double pricing where one roof runs up over another at intersections.
- **Add** a pilot car if trusses are 11'6" wide.

Once you've doubled the base price of the truss, it doesn't get much worse.

Think about this: A 12/12 roof pitch has 40% more area to cover with shingles than a 4/12 roof pitch and is costly to make and place.

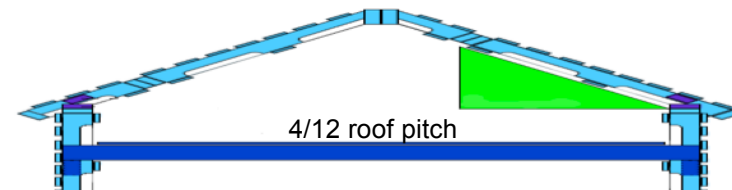
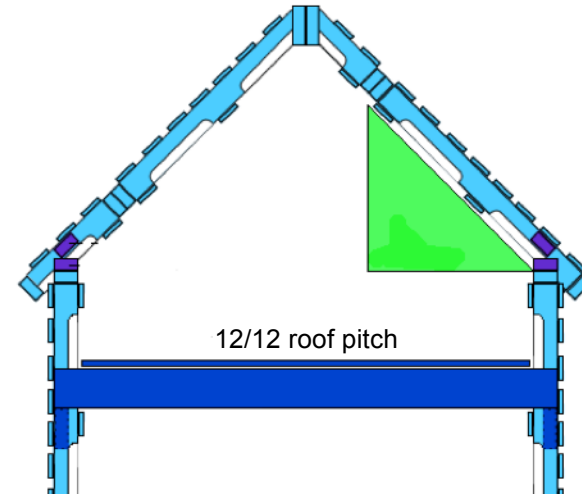

Hit the back button to return to the website



**Alpha Truss**

In Touch and on time

Alphatruss.ca